

GROUND FLOOR PLAN
 AREA - 858.80 sqm (9240.89 sqft.)
 (SCALE 1:75)

SCHEDULE OF DOORS & WINDOWS					
SL. NO.	TYPE	WIDTH	HEIGHT	NOS.	DESCRIPTION
1	D	1500	2400	2	DOUBLE PANEL WOODEN DOOR
2	D1	1200	2100	20	DOUBLE PANEL WOODEN DOOR
3	D2	750	2100	20	SINGLE PANEL WOODEN DOOR
4	W	1500	1200	11	STEEL FRAME GLAZED WINDOW
5	W1	1200	1200	22	STEEL FRAME GLAZED WINDOW
6	W2	900	1200	8	STEEL FRAME GLAZED WINDOW
7	W3	900	600	2	STEEL FRAME GLAZED WINDOW
8	W4	2500	1500	4	STEEL FRAME GLAZED WINDOW
9	S.W	1800	1500	1	SERVICE WINDOW
10	V	600	800	10	STEEL GLAZED VANTILATION
11	V1	1200	300	18	STEEL GLAZED VANTILATION
12	FGL	2200	2100	2	GLAZED VANTILATION
13	BFG	3000	2400	1	BI FOLD GRILL

Drinking water provision done
 Panjay Singh
 11-7-18

BIHAR STATE EDUCATIONAL INFRASTRUCTURE
 DEVELOPMENT CORPORATION LTD.
 SHIKSHA BHAWAN, SAIDPUR, PATNA

11-7-18		Panjay Singh	
DRAUGHTSMAN BSEIDC, PATNA	ARCH. BSEIDC, PATNA	SENIOR (ARCH.) BSEIDC, PATNA	C.E. BSEIDC, PATNA

PROJECT	PROPOSED CONSTRUCTION OF GIRL'S HOSTEL FOR 100 STUDENTS (DIET, PTEC, CTE, BITE)
DEPT.	BIHAR STATE EDUCATIONAL INFRASTRUCTURE DEVELOPMENT CORPORATION LTD. SHIKSHA BHAWAN, SAIDPUR, PATNA
ARCHT. AND CONSULTANT	RDCS RANCHI DESIGN & CONSULTANCY SERVICES PVT. LTD. SOUTH OFFICE PARA, NEAR ST. XAVIER SCHOOL DORANDA, RANCHI-834002

REV.	DESCRIPTION	DATE	BY
△	GENERAL REVISION	26.11.14	SUNIL
△	GENERAL REVISION	29.04.14	J.P

NOTES:-
 1. ALL DIMENSIONS AND LEVELS ARE IN mm. & FIGURED DIMENSIONS SHALL BE FOLLOWED.
 2. ±0.00 LEVEL CORRESPONDS TO PLINTH LEVEL (P.L.) OF BUILDING. WHICH IS 600mm ABOVE FINISHED GROUND LEVEL (G.L.).

- ALL RCC WORK SHALL BE OF M25 GRADE CONCRETE.
- BRICKWORK SHALL BE WITH 100A BRICKS IN CEMENT MORTAR 1:6.

CHECKED & APPROVED	S.L. GOPE	GROUND FLOOR PLAN DRG. NO. - RDCS/BSEIDC/0033/HQS/001
DESIGN BY	S.A.	
DRAWN BY	J.P.	
SIZE-	SCALE 1:75	REV R=2

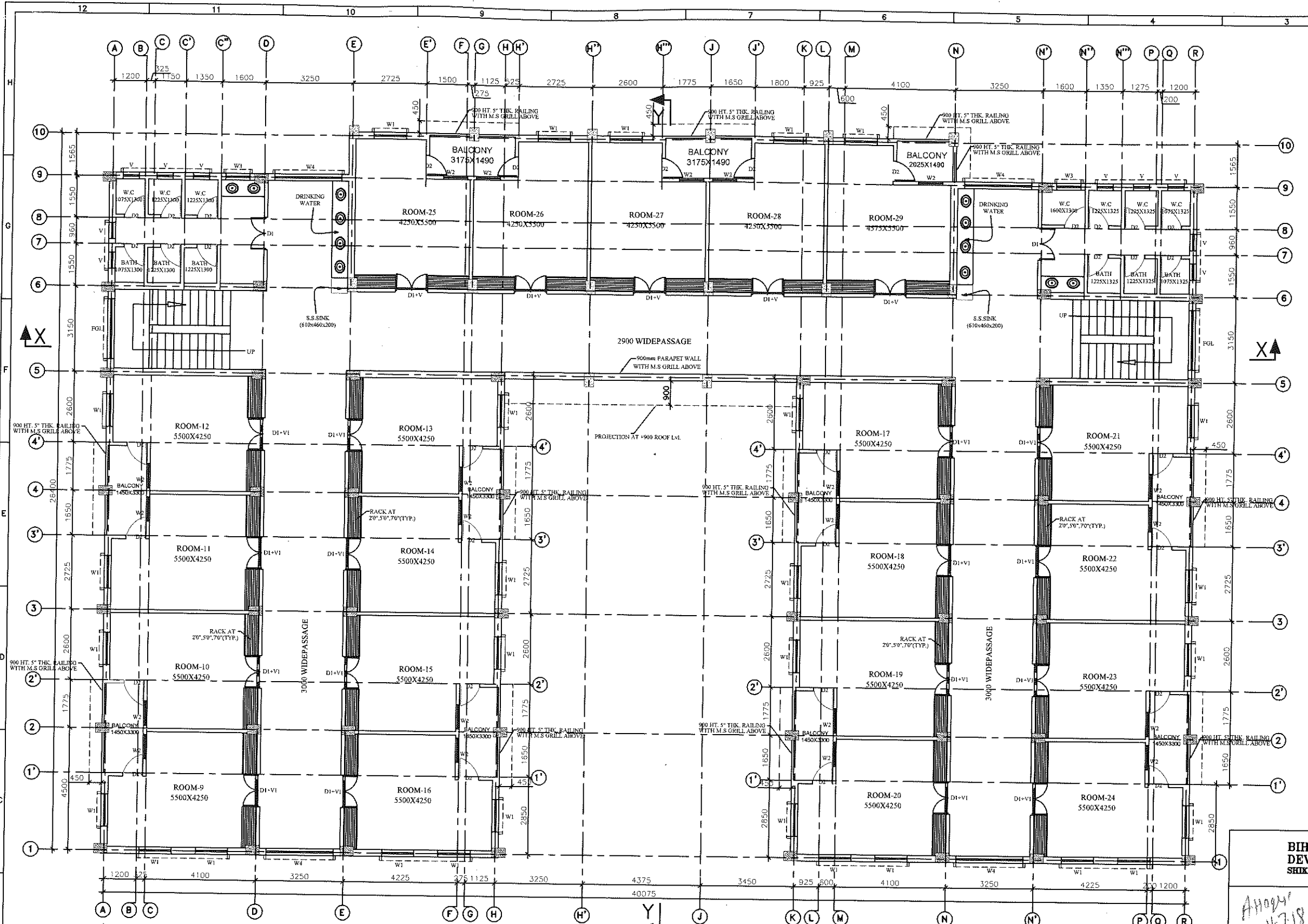

SCHEDULE OF DOORS & WINDOWS					
SL. NO.	TYPE	WIDTH	HEIGHT	NOS.	DESCRIPTION
1	D1	1200	2100	23	DOUBLE PANEL WOODEN DOOR
2	D2	750	2100	33	SINGLE PANEL WOODEN DOOR
3	W	1500	1200	8	STEEL FRAME GLAZED WINDOW
4	W1	1200	1200	21	STEEL FRAME GLAZED WINDOW
5	W2	900	1200	21	STEEL FRAME GLAZED WINDOW
6	W3	900	600	2	STEEL FRAME GLAZED WINDOW
7	W4	2000	1200	4	STEEL FRAME GLAZED WINDOW
8	V	600	600	10	STEEL GLAZED VENTILATION
9	V1	1200	300	21	STEEL GLAZED VENTILATION
10	FGL	2200	2100	2	GLAZED VENTILATION

FIRST FLOOR PLAN
 AREA - 858.80 sqm (9240.69 sqft.)
 (SCALE 1:75)

*Drinking water provision done.
 Part of G.L.
 11-7-18*

BIHAR STATE EDUCATIONAL INFRASTRUCTURE DEVELOPMENT CORPORATION LTD.
 SHIKSHA BHAWAN, SAIDPUR, PATNA

<i>Archd 11-7-18</i>		<i>Part of G.L. 11-7-18</i>	
DRAUGHTSMAN BSEIDC, PATNA	ARCH. BSEIDC, PATNA	SENIOR (ARCH.) BSEIDC, PATNA	C.E. BSEIDC, PATNA

PROJECT	PROPOSED CONSTRUCTION OF GIRL'S HOSTEL FOR 100 STUDENTS (DIET, PTEC, CTE, BITE)		
DEPT.	BIHAR STATE EDUCATIONAL INFRASTRUCTURE DEVELOPMENT CORPORATION LTD. SHIKSHA BHAWAN, SAIDPUR, PATNA		
ARCHT. AND CONSULTANT	RANCHI DESIGN & CONSULTANCY SERVICES PVT. LTD. SOUTH OFFICE PARA, NEAR ST. XAMIER SCHOOL DORANDA, RANCHI-834002		

CHECKED & APPROVED	S.L. GOPE	FIRST FLOOR PLAN
DESIGN BY	S.A.	
DRAWN BY	J.P.	
SIZE-	SCALE 1:75	DRG. NO. -RDCS/BSEIDC/0033/HOS/001 SHEET 2 OF 4 REV R-2

- NOTES:-**
1. ALL DIMENSIONS AND LEVELS ARE IN mm. & FIGURED DIMENSIONS SHALL BE FOLLOWED.
 2. ±0.00 LEVEL CORRESPONDS TO PLINTH LEVEL(P.L.) OF BUILDING, WHICH IS 600 ABOVE FINISHED GROUND LEVEL(G.L.).
 3. ALL RCC WORK SHALL BE OF M25 GRADE CONCRETE.
 4. BRICKWORK SHALL BE WITH 100A BRICKS IN CEMENT MORTAR 1:6.

REV.	DESCRIPTION	DATE	BY
△	GENERAL REVISION	26.11.14	SUNIL
△	GENERAL REVISION	29.04.14	J.P.

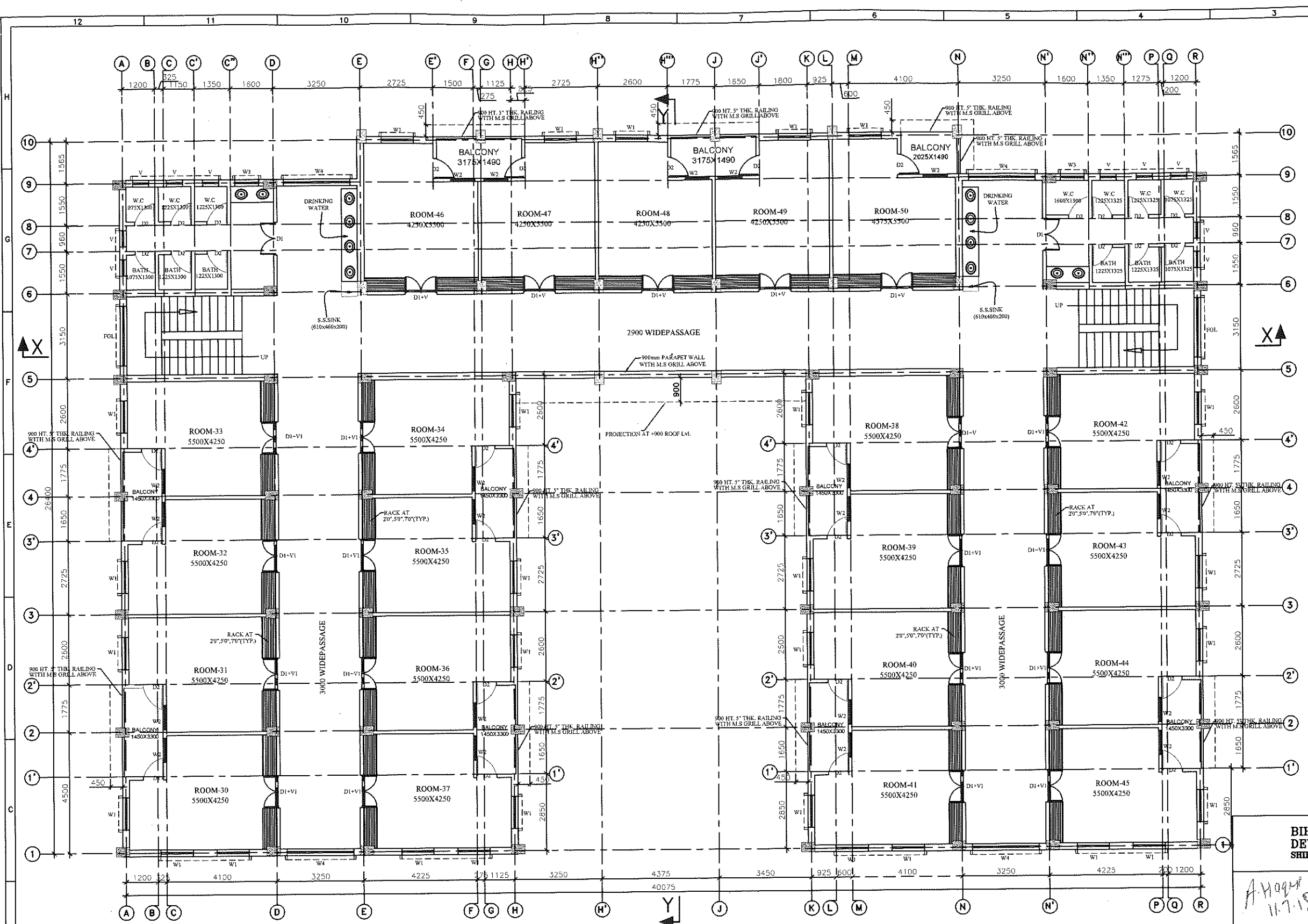

SCHEDULE OF DOORS & WINDOWS					
SL.NO.	TYPE	WIDTH	HEIGHT	NOS.	DESCRIPTION
1	D1	1200	2100	23	DOUBLE PANEL WOODEN DOOR
2	D2	750	2100	33	SINGLE PANEL WOODEN DOOR
3	W	1500	1200	4	STEEL FRAME GLAZED WINDOW
4	W1	1200	1200	21	STEEL FRAME GLAZED WINDOW
5	W2	900	1200	21	STEEL FRAME GLAZED WINDOW
6	W3	900	600	2	STEEL FRAME GLAZED WINDOW
7	W4	2500	1200	4	STEEL FRAME GLAZED WINDOW
8	V	600	600	10	STEEL GLAZED VENTILATION
9	V1	1200	300	21	STEEL GLAZED VENTILATION
10	FGL	2200	2100	2	GLAZED VANTILATION

SECOND FLOOR PLAN
 AREA - 858.80 sqm (9240.69 sqft.)
 (SCALE 1:75)

*Drinking water provision done.
 Panjay G
 11-7-18*

BIHAR STATE EDUCATIONAL INFRASTRUCTURE DEVELOPMENT CORPORATION LTD.
 SHIKSHA BHAWAN, SAIDPUR, PATNA

<i>A.H.O.G.M. 11-7-18</i>	ARCH. BSEIDC, PATNA	<i>Panjay G 11-7-18</i>	SENIOR (ARCH.) BSEIDC, PATNA	C.E. BSEIDC, PATNA
DRAUGHTSMAN BSEIDC, PATNA				

PROJECT	PROPOSED CONSTRUCTION OF GIRL'S HOSTEL FOR 100 STUDENTS (DIET, PTEC, CTE, BITE)
DEPT.	BIHAR STATE EDUCATIONAL INFRASTRUCTURE DEVELOPMENT CORPORATION LTD. SHIKSHA BHAWAN, SAIDPUR, PATNA
ARCHT. AND CONSULTANT	RANCHI DESIGN & CONSULTANCY SERVICES PVT. LTD. SOUTH OFFICE PARA, NEAR ST. XAMIER SCHOOL DORANDA, RANCHI-834002

- NOTES:-**
- ALL DIMENSIONS AND LEVELS ARE IN mm. & FIGURED DIMENSIONS SHALL BE FOLLOWED.
 - ±0.00 LEVEL CORRESPONDS TO PLINTH LEVEL(P.L.) OF BUILDING. WHICH IS 600 ABOVE FINISHED GROUND LEVEL(G.L.).
 - ALL RCC WORK SHALL BE OF M25 GRADE CONCRETE.
 - BRICKWORK SHALL BE WITH 100A BRICKS IN CEMENT MORTAR 1:6.

REV.	DESCRIPTION	DATE	BY
△	GENERAL REVISION	26.11.14	SUNIL
△	GENERAL REVISION	29.04.14	J.P

CHECKED & APPROVED	S.L.GOPE	SECOND FLOOR PLAN
DESIGN BY	S.A.	
DRAWN BY	J.P.	
SIZE-	SCALE 1:75	DRG. NO.-RDCS/BSEIDC/0033/HOS/001
		SHEET 3 OF 4
		REV R-2